



NETWORK PUBLIC VIEW DISPLAY (NPVD) SYSTEMS

NPVDxxA Series

INSTALLATION AND OPERATING INSTRUCTIONS
WWW.AIGISMECH.COM

IMPORTANT SAFEGUARDS



ATTENTION – Observe Precautions For Handling Electrostatic Sensitive Devices

1. Read Instructions - All the safety and operating instructions should be read before the unit is operated.
2. Retain Instructions - The safety and operating instructions should be retained for future reference.
3. Heed Warnings - All warnings on the unit and in the operating instructions should be adhered to.
4. Follow Instructions - All operating and use instructions should be followed.
5. Cleaning - Unplug the unit from the outlet before cleaning. Do not use liquid cleaners or aerosol cleaners. Use a damp cloth for cleaning.
6. Attachments - Do not use attachments not recommended by the product manufacturer as they may cause hazards.
7. Accessories - Do not place this unit on an unstable stand, tripod, bracket, or mount. The unit may fall, causing serious injury to a person and serious damage to the unit. Use only with a stand, tripod, bracket, or mount recommended by the manufacturer or sold with the product. Any mounting of the unit should follow the manufacturer's instructions and should use a mounting accessory recommended by the manufacturer.
8. Ventilation - Openings in the enclosure, if any, are provided for ventilation, to ensure reliable operation of the unit, and to protect it from overheating. These openings must not be blocked or covered. This unit should not be placed in a built-in installation unless proper ventilation is provided or the manufacturer's instructions have been adhered to.
9. Power Sources - This unit should be operated only from the type of power source indicated on the marking label. If you are not sure of the type of power supply you plan to use, consult your appliance dealer or local power company. For units intended to operate from battery power or other sources, refer to the operating instructions.
10. Grounding or Polarization - This unit may be equipped with a polarized alternating-current line plug (a plug having one blade wider than the other). This plug will fit into the power outlet only one way. This is a safety feature. If you are unable to insert the plug fully into the outlet, try reversing the plug. If the plug should still fail to fit, contact your electrician to replace your obsolete outlet. Do not defeat the safety purpose of the polarized plug. Alternately, this unit may be equipped with a 3-wire grounding-type plug, a plug having a third (grounding) pin. This plug will only fit into a grounding-type power outlet. This is a safety feature. If you are unable to insert the plug into the outlet, contact your electrician to replace your obsolete outlet. Do not defeat the safety purpose of the grounding-type plug.
11. Power Cord Protection - Power supply cords should be routed so that they are not likely to be walked on or pinched by items placed upon or against them, paying particular attention to cords and plugs, convenience receptacles, and the point where they exit from the appliance.
12. Power Lines - An outdoor system should not be located in the vicinity of overhead power lines or other electric light or power circuits or where it can fall into such power lines or circuits. When installing an outdoor system, extreme care should be taken to keep from touching such power lines or circuits as contact with them might be fatal. U.S.A. models only - refer to the National Electrical Code Article 820 regarding installation of CATV systems.
13. Overloading - Do not overload outlets and extension cords as this can result in system failure.
14. Object and Liquid Entry - Never push objects of any kind into this unit through openings, as they may touch dangerous voltage points or short out parts that could result in a fire or electric shock. Never spill liquid of any kind on the unit.
15. Servicing - Do not attempt to service this unit yourself as opening or removing covers may expose you to dangerous voltage or other hazards. Refer all servicing to qualified service personnel.
16. Damage Requiring Service - Unplug the unit from the outlet and refer servicing to qualified service personnel under the following conditions:
 - a. When the power supply cord or plug is damaged.
 - b. If liquid has been spilled or objects have fallen into the unit.
 - c. If the unit has been exposed to rain or water.
 - d. If the unit does not operate normally by following the operating instructions. Adjust only those controls that are covered by the operating instructions, as an improper adjustment of other controls may result in damage and will often require extensive work by a qualified technician to restore the unit to its normal operation.
 - e. If the unit has been dropped or the cabinet has been damaged.
 - f. When the unit exhibits a distinct change in performance--this indicates a need for service.
17. Replacement Parts - When replacement parts are required, be sure the service technician has used replacement parts specified by the manufacturer or have the same characteristics as the original part. Unauthorized substitutions may result in fire, electric shock, or other hazards.
18. Coax Grounding - If an outside cable system is connected to the unit, be sure the cable system is grounded. U.S.A. models only--Section 810 of the National Electrical Code, ANSI/NFPA No.70-1981, provides information with respect to proper grounding of the mount and supporting structure, grounding of the coax to a discharge unit, size of grounding conductors, location of discharge unit, connection to grounding electrodes, and requirements for the grounding electrode.

What is Electrostatic Discharge?

A transfer of electrostatic charges between bodies at different electrostatic potentials caused by direct contact or induced by an electrostatic field. The following are some examples of electrostatic charges:

1. Walking across a nylon carpet on a dry day generates a static electrical charge of 35,000 volts.
2. Opening a plastic bag generates a charge of 20,000 volts.



Warning: In a domestic environment, this product may cause radio interference in which case the user may be required to take adequate measures.



WARNING: Do not make repairs yourself. Do not attempt to remove the cover of the NPVD. Do not disassemble it or remove any parts. You run the risk of electric shock and voiding the warranty. No user-serviceable parts are inside.

SAFETY PRECAUTIONS



CAUTION
RISK OF ELECTRIC SHOCK. DO NOT OPEN!



CAUTION: TO REDUCE THE RISK OF ELECTRICAL SHOCK, DO NOT OPEN COVERS. NO USER SERVICEABLE PARTS INSIDE. REFER SERVICING TO QUALIFIED SERVICE PERSONNEL.

This label may appear on the bottom of the unit due to space limitations.



The lightning flash with an arrowhead symbol within an equilateral triangle is intended to alert the user to the presence of uninsulated "dangerous voltage" within the product's enclosure that may be of sufficient magnitude to constitute a risk of electric shock to persons.



The exclamation point within an equilateral triangle is intended to alert the user to presence of important operating and maintenance (servicing) instructions in the literature accompanying the appliance.

1. UNPACKING

Unpack carefully. This is an electromechanical device and should be handled carefully. Remove all of the items from the box. It is recommended that you do not remove the clear protective plastic covers on the NPVD at this time. Check to ensure that the following items are included:

- Network Public View Display (NPVD) LCD Monitor
- Remote Control
- ADS Software User Guide
- This Instruction Book

2. SERVICE

If the unit needs repair service or parts, contact Aigis Mechtronics for authorization to return as well as shipping instructions.

3. DESCRIPTION

All NPVD models include a high resolution LCD screen with remote and on-screen display and operate on 110VAC/60Hz input voltage.

– Models *without an on-board camera* include one BNC input and a looping BNC output, a light sensor to reduce energy demands, and an audio input.

–Models *with an on-board camera* have motion detection, picture-in-picture, and an additional BNC output for the internal camera.

All NPVD Products include the capability to connect to a website that allows a remote user to alter the content being displayed on the monitor.



IMPORTANT: The installer must initialize this online function on-site prior to completing the installation. This is done by:

- Logging into a website (website and login info provided by customer)
- Downloading a file onto a USB Flash drive (the contents of this file are unique to each monitor)
- Inserting the USB Flash drive into a slot in the monitor

Detailed instructions regarding this process are provided in **Section 4.5**.

Construction/Finish: Fabricated aluminum case (black).

Part numbers	Camera Type	Lens Type	Input Power	Power Consumption
NPVD26A-6NN-B	None	N/A	110VAC ± 10%, 60Hz	125W
NPVD26A-6CH21 IAMP-B	Color Hi-Res	2.8-11mm, AI		125W
NPVD26A-6WD21 IAMP-B	Wide Dynamic	2.8-11mm, AI		125W
NPVD32A-6NN-B	None	N/A		150W
NPVD32A-6CH21 IAMP-B	Color Hi-Res	2.8-11mm, AI		150W
NPVD32A-6WD21 IAMP-B	Wide Dynamic	2.8-11mm, AI		150W

NPVD SPECIFICATIONS

LCD Panel	NPVD26	NPVD32	NPVD37
Resolution	1366H x 768V Pixels WXGA		
Pixel Pitch	0.1405mm x 0.4215mm	0.170mm x 0.510mm	0.200mm x 0.600mm
Brightness	600 cd/m ²		
Contrast Ratio	1400 : 1	1600 : 1	
Viewing Angle	178 / 178 U/D/L/R		
Color Depth	8bit / 16.7M Colors		
Response Time	8ms		
Lamp Life	50,000+ Hours		

Monitor Features	NPVD26	NPVD32	NPVD37
Video Feeds	Internal Camera Out, External Video In, External Video Loop Out		
Video Connectors	3 x BNC Connectors		
Picture-In-Picture	OSD Controls Size (Sm, Lg, Split) and Location of PIP Window		
VESA Standard Compatible	75mm and 100mm Hole Patterns		
Construction	Aluminum Casing with Acrylic Accessory Window, Powder Coated White or Black		
Motion Sensor	OSD Controls Sensitivity, Action Upon Motion and Dwell Time		
Light Sensor	OSD Controls Sensitivity		
Remote Controller	14 Button Remote, Batteries Included		
Video System	NTSC		
Speaker Power	2 Watts per Channel, 2 Channels		
Input Power	115VAC, +/- 10%		
Power Requirement	125W	150W	175W

NPVD SPECIFICATIONS (continued)

Camera Specifications		
Camera Type	Color Hi-Res	Wide Dynamic
Image Sensor	1/3" Sony Super HAD CCD	1/3" Pixim DPS Sensor
Signal System	NTSC	NTSC
Effective Pixels	768 (H) x 494 (V)	720 (H) x 480 (V)
Resolution	540TVL	
Mimumum Illumin	0.1Lux/F1.2	0.5Lux/F1.2;0.08
Dynamic Range	n/a	101dB Typ., 120dB Max
S/N Ratio	>48dB	>50dB
Control Method	n/a	OSD
Electronic Shutter	1/60 - 1/100,000 sec	Auto
White Balance	Auto	ATW/AWB/Manual/ATW Extend
AGC	Auto	
BLC	Auto	
Gamma Correction	0.45	
Lens	2.8-11mm Auto-Iris	
Power Supply	12VDC	12VDC / 24VAC
Operating Temperature	-10°C ~ +50°C (+14°F ~ +122°F), 90% RH Max	

Network Features, All Models		
Network Connector	1 x RJ45 Ethernet Port	
Network Type	Intranet or Internet	
Supported Formats	Text	Formattable .TXT Files
	Images & Slideshow	JPEG, .GIF
User Interface	Software as a Service web interface, accessed via Microsoft Internet Explorer or Mozilla Firefox.	
Security Features	Password-protected SSL website login, user permission levels, secure content retrieval.	
Content Retrieval	Monitor is hard-coded to view only one website for content retrieval.	
Content Management	Internet based playlist scheduling.	
Scope of Control	Remotely control screen content of multiple monitors in any location.	
Emergency Messaging	Allows images and/or text to be displayed on a monitor or group of monitors within one minute of execution.	
Event Logging	Playlist on-screen duration, loss of signage connectivity, and content downloads are all recorded as events.	

4. INSTALLATION

Attention: Installations should be performed by qualified service personnel only in accordance with the National Electrical Code or applicable local codes.

4.1 Mounting

For specific directions on mounting the Monitor see the Instruction Book that came with your mount.

Use eight (8) #10-24 screws when mounting the NPVD unit to your mount. Ensure that the mounting screws do not exceed 0.500 inches in length.

4.2 Power Connections 110VAC

If your unit uses a 110VAC/60Hz Power Supply see either **Section 4.2.1** or **4.2.2** (as applicable for your installation depending on the way the power will be directed to the unit).

4.2.1 Power Connection with provided Cord

The NPVD can be powered with the included Power Cord (A) by plugging directly into the power receiver (B) located on the back of the monitor see **Figure 1a**.

Power Cord Protection - Power supply cords should be routed so that they are not likely to be pinched by items placed upon or against them, paying particular attention to cords and plugs and the point where they exit from the appliance.

4.2.2 Using the Right Angle Power Connector

To use your own power leads, a Right Angle Power Connector (C) may be used (Not Included) see **Figure 1a**.

1. After a qualified electrician wires the right angle connector (C), plug the connector into the power receiver (B) located on the back of the NPVD.

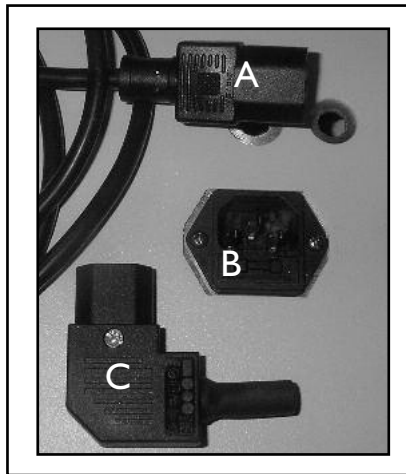

Figure 1a: Back View - 110VAC Power Connections

4.3 Video Connections

1. Connect the external video source to the cable “Video In”.
If you wish to run the video back out to a monitoring station, attach the “Video Out” connector to the input of your external monitor. See **Figure 1b** for connector locations.

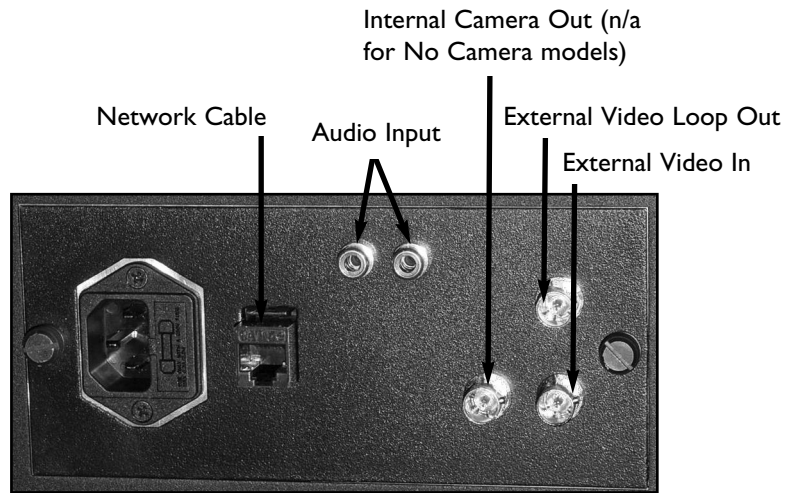

Figure 1b: Back View - NPVD Connectors

4.4 Network Connection

Run a Cat 5e/6 network cable to the installation site. Plug the cable into the RJ45 jack shown in Figure 1b.

4.5 NPVD Initialization Procedure

Note: This procedure must be completed during installation to enable the remote content management feature.

1. Log in to the customer website using the provided login details. If the customer did not supply the installer with the necessary details, contact Aigis Mechtronics for instructions. See **Figure 2**.

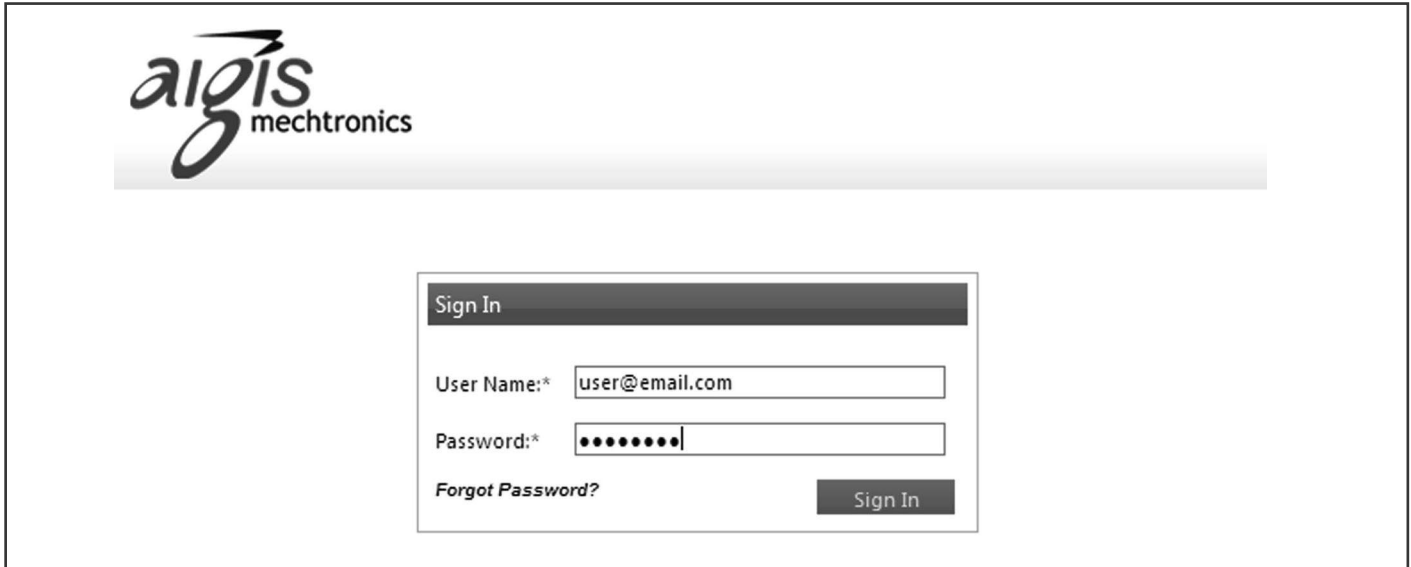

Figure 2: Log in Screen

2. Once logged in, open the 'System Settings' tab on the left side, and then select 'Download Initial Setup' See **Figure 3**.

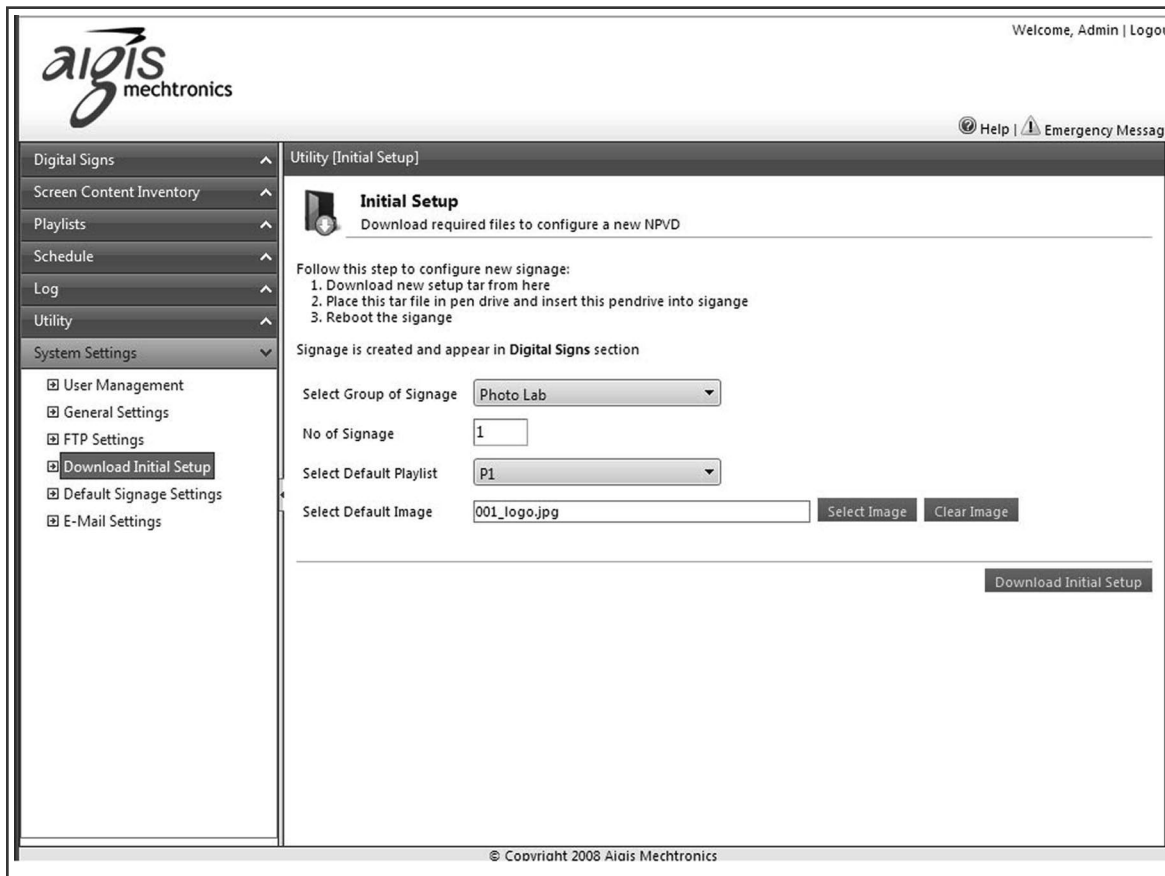

Figure 3: System Settings Tab

3. Under 'Select group of signage', pick the directory that the sign is to be placed in.
4. For 'Number of Signage', select the number of signs that are going to be programmed with this particular setup (similar folder locations, default playlist, and default image). This will be 'one' most of the time.
5. For 'Select Default Playlist', select the playlist that will be displayed initially by the sign.
6. For 'Select Default Image', select the image that will show upon initial booting of the sign, and if the sign drops from the network.
7. Once everything is selected, hit 'Download Initial Setup' to download the USBSetup.tar file generated by the server.
8. Copy this file over to the USB key. Make sure it doesn't get renamed if there are multiple copies (i.e. USBSetup(2).tar will NOT work).
9. Insert the programmed USB key into one of the USB slots. See **Figure 4**.

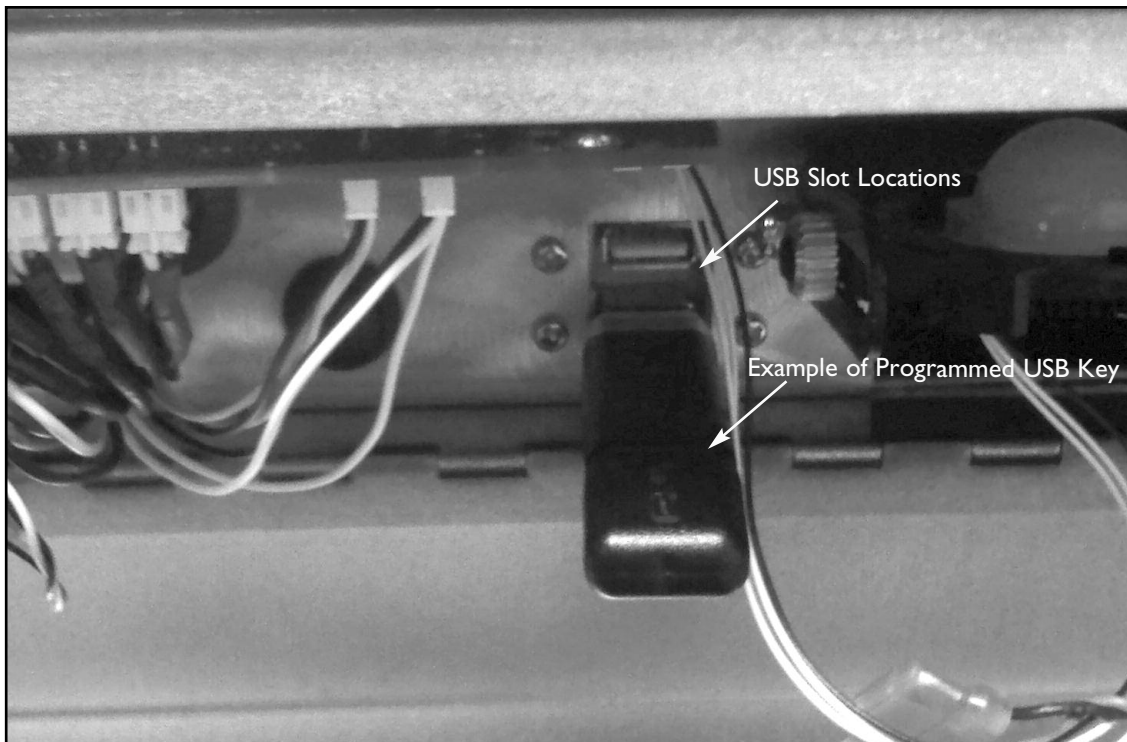

Figure 4: Internal USB Slot location

10. A picture should come up on the screen. The picture will then close, showing the Aigis background again. Then, a playlist will begin to play the default playlist. Remove the USB key. Wait for the sign to boot back up. It should display the new content. Unplug the sign to finish the installation.

5. USING THE MENUS

OVERVIEW

On Screen Display Menus

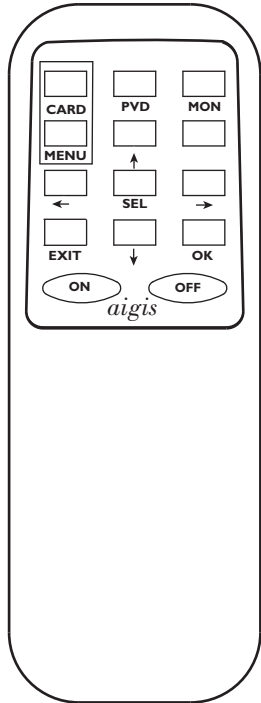

Press **SEL** to enter and exit the menu.

Press **PVD** to enter and exit the menu.

Press **MON** to enter and exit the menu.

Menu	Description
SEL MENU	Use this menu to directly access the video input for the Main Video input of the on screen display. Best used to bypass the PVD menu for confirmation of video input selected during setup.
PVD MENU	The PVD Menu is used to make adjustments to the factory default settings. Access this menu to change options and settings for both the internal and external video sources, the motion sensor, light sensor, picture in picture (PIP) settings and the switcher. Access any advanced setup options (if the unit is equipped with these features) under this menu .
MON MENU	The MON Menu allows for minor adjustments to the picture quality of the monitor such as brightness, contrast, color, sharpness and tint.

5.1 NAVIGATING THE MENUS

Note: To power the entire unit on or off, disconnect the power source.

To Do This...	Press
Turn On LCD	On
Turn Off the LCD	Off
Display the Main Menus	PVD, MON, or SEL
Move through the Menus	↑ ↓
Choose Sub Menu	SEL
Move through the Sub Menu options	→
To Do This...	Press
Confirm changes	OK
Save changes in Sub Menu	OK → Yes
Do not save changes in Sub Menu	OK ← No
Exit Sub Menu	EXIT
Exit Main Menus	PVD or MON or SEL

Menus

5.2 Using the SEL Menu

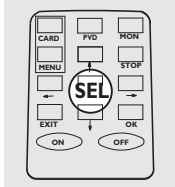

When no menus are open on the screen, pressing the SEL button will bring up the menu shown

This menu allows the user to select the input to be shown on-screen, and can act as an override to the PVD Menu (described in the following section).

Note: Power-cycling the unit will cause the monitor to revert to the settings stored in the PVD Menu, not the SEL Menu.

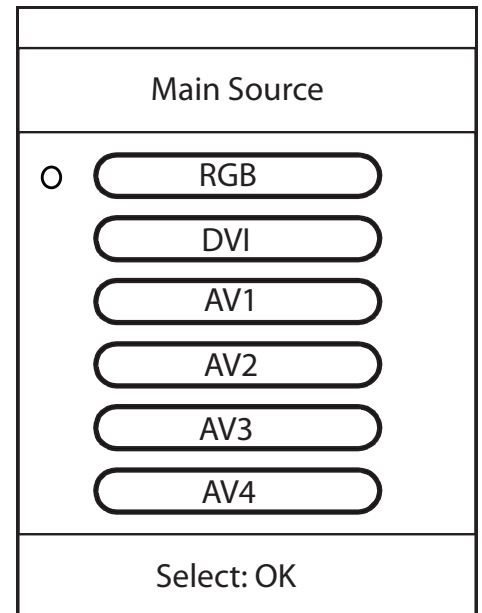

5.3 Using the PVD Main Menu

To Access the PVD Menu

Press PVD

PVD MAIN MENU

MAIN VIDEO SETUP

MOTION SENSOR SETUP

LIGHT SENSOR SETUP

SWITCHER VIDEO SETUP

ADVANCED SETUP

To Do This...	Press
Move through the Menus	↑ ↓
Choose Sub Menu	SEL
Move through the Sub Menu options	→
Save - Sub Menu	OK → Yes
Do Not Save - Sub Menu	OK ← No
Exit Sub Menu	EXIT
Exit Main Menus	PVD

5.4 Using the Main Video Setup Menu

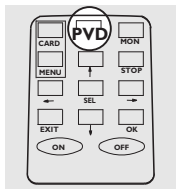

Access the menu by pressing the PVD button.
Press the ↓ to choose Main Video Setup.
Press SEL.

Use this menu to select the Main Video Source and PIP (Picture in Picture) settings.

MAIN VIDEO SETUP
VIDEO SOURCE
PIP VIDEO SOURCE
PIP SIZE
PIP LOCATION

Main Video Setup - Menu Options

• - Option Included X - Option Not Included

Feature	Option	Description	PVD Type	
			On Board Camera	No Camera
Video Source <i>Selects the Main Video source.</i>	Digi Media	Content from Website	•	•
	Int Cam	Internal built in Camera	•	X
	Ext Video 1	External Video Source 1	•	•
	Ext Video 2	External Video Source 2	•	X
	DVI, INT card	Not used	X	X
PIP Video Source <i>Selects PIP video source the Main Video.</i>	Digi Media	Content from Website	•	X
	Int Cam	Internal built in Camera	•	X
	Ext Video 1	External Video Source 1	•	X
	Ext Video 2	External Video Source 2	•	X
	DVI, INT card	Not used	X	X
	No PIP	No PIP will display	•	X
PIP Size <i>Selects the size of all PIP windows.</i>	Small	Small PIP window	•	X
	Large	Large PIP window	•	X
	Split	Split Screen proportionately	•	X
	Split/Full	Split Screen stretches and fills the screen	•	X
PIP Location <i>Selects the on screen location for all PIP windows.</i>	Top L	Top Left	•	X
	Top R	Top Right	•	X
	Bottom R	Bottom Right	•	X
	Bottom L	Bottom Left	•	X

Note: Video Source and PIP Video Source cannot be set to the same input source.

5.4.1 Troubleshooting “No Signal” Message

No Signal Blue Box

Setting the Video Source (in the Main Video Setup menu) to an input that is not currently connected will bring up a blue box that says “No Signal” followed by the current input setting (i.e. No Signal DVI). Pressing the PVD button is ineffective because the system is trying to overlay the menu over the input image (which is blank). To fix this problem try the following:

1. Press the SEL button to bring up the SEL Menu (see **Section 5.2**).
2. Press Up or Down and highlight a source with active video (typically RGB).
3. Press the OK button. The video source will change. If this video source is active (i.e. the No Signal message is not displayed), the PVD button will be functional again.
4. Press the PVD button, select Main Video Setup, and change the Video Source to the correct setting (i.e. DigiMedia or INT Cam).
5. Press the OK button then the Right arrow button to save the settings. Press PVD again to clear the “OK” message.

5.5 Using the Motion Sensor Setup Menu

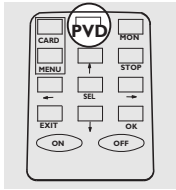

Access the menu by pressing the **PVD** button.
Press the ↓ to choose **Motion Sensor Setup**.
Press **SEL**.

After motion is detected by the Motion Sensor the on screen video will switch to the Motion Sensor settings set in this menu and stay on screen for between 5-59 seconds.

MOTION SENSOR SETUP
VIDEO SOURCE
PIP VIDEO SOURCE
SENSITIVITY
DWELL TIME
SENSOR ON/OFF

Use this menu to activate and setup the video, PIP, sensitivity and dwell time for the Motion Sensor.

Motion Sensor Setup - Menu Options

• - Option Included X - Option Not Included

Feature	Option	Description	PVD Type	
			On Board Camera	No Camera
Video Source <i>Selects the Main Video source.</i>	Digi Media	Content from Website	•	X
	Int Cam	Internal built in Camera	•	X
	Ext Video 1	External Video Source 1	•	X
	Ext Video 2	External Video Source 2	•	X
	DVI, Int Card	Not used	X	X
PIP Video Source <i>Selects PIP video source.</i>	Digi Media	Content from Website	•	X
	Int Cam	Internal built in Camera	•	X
	Ext Video 1	External Video Source 1	•	X
	Ext Video 2	External Video Source 2	•	X
	DVI, Int Card	Not used	X	X
	No PIP	No PIP will display	•	X
Sensitivity <i>Sets how sensitive the Motion Sensor is to Motion.</i>	1-10	1 = not sensitive 10 = most sensitive	•	X
Dwell Time <i>Selects the length of time the Motion Sensor settings will remain on screen.</i>	5-59	Choose in seconds the length of time the Motion Sensor Settings will play after motion is detected before switching back to Main Video settings.	•	X
Sensor on/off <i>Activate or Deactivate the motion sensor.</i>	On	Activates Motion Sensor	•	X
	Off	Deactivates Motion Sensor	•	X

Note: Video Source and PIP Video Source cannot be set to the same input source.

5.6 Using the Light Sensor Setup Menu

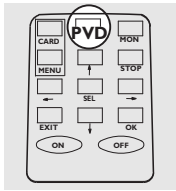

Access the menu by pressing the PVD button.
Press the ↓ to choose Light Sensor Setup.
Press SEL.

After a change in ambient light is detected the video will switch to the Light Sensor settings chosen in this menu.

These settings will stay active until an increase in ambient light occurs to reactivate the Main Video settings.

LIGHT SENSOR SETUP
VIDEO SOURCE
PIP VIDEO SOURCE
SENSITIVITY
ACTIVATION DELAY
SENSOR ON/OFF

Use this menu to setup the video, PIP, sensitivity and activation delay for the Light Sensor.

Light Sensor Setup - Menu Options

• - Option Included X - Option Not Included

Feature	Option	Description	PVD Type	
			On Board Camera	No Camera
Video Source <i>Selects the Light Sensor video source.</i>	Digi Media	Content from Website	•	X
	Power Save	Turns the LCD backlight off	•	X
	Int Cam	Internal built in Camera	•	X
	Ext Video 1	External Video Source 1	•	X
	Ext Video 2	External Video Source 2	•	X
	DVI , Int Card	Not used	X	X
PIP Video Source <i>Selects the PIP video source for the Light Sensor.</i>	Digi Media	Content from Website	•	•
	Int Cam	Internal built in Camera	•	X
	Ext Video 1	External Video Source 1	•	X
	Ext Video 2	External Video Source 2	•	X
	DVI , Int Card	Not used	X	X
	No PIP	No PIP will display	•	X
Sensitivity <i>Sets how sensitive the Light Sensor is to a change in ambient light.</i>	1-10	1 = not sensitive 10 = most sensitive	•	•
	Activation Delay	Choose 1, 2 or 3 minutes	•	•
Activation Delay <i>The amount of time set to delay activation of the Light Sensor settings.</i>	Off	No Delay		
	Sensor On/Off	Activates Light Sensor	•	•
Sensor On/Off <i>Activate or Deactivate the Light Sensor.</i>	Off	Deactivates Light Sensor	•	•

Note: Video Source and PIP Video Source cannot be set to the same input source.

Note: After a change in ambient light is detected the Light Sensor settings can be set to delay activation between 1-3 minutes.

5.7 Using the Switcher Video Setup Menu

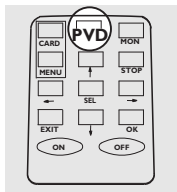

Access the menu by pressing the PVD button.
Press the ↓ to choose Switcher Video Setup.
Press SEL.

Use this menu to setup PVD units with multiple video inputs. Set an additional video source and PIP to activate upon a preset dwell rate and set the dwell rate for the Main Video settings once the Run Switcher is set to ON.

SWITCHER VIDEO SETUP
VIDEO SOURCE
PIP VIDEO SOURCE
RUN SWITCHER
SWITCHER DWELL
MAIN VIDEO DWELL

• - Option Included X - Option Not Included

Switcher Video Setup - Menu Options

Feature	Option	Description	PVD Type	
			On Board Camera	No Camera
Video Source <i>Selects the Light Sensor video source.</i>	Digi Media	Content from Website	•	X
	Power Save	Turns the LCD backlight off	•	X
	Int Cam	Internal built in Camera	•	X
	Ext Video 1	External Video Source 1	•	X
	Ext Video 2	External Video Source 2	•	X
	DVI, Int Card	Not used	X	X
PIP Video Source <i>Selects the PIP video source for the Light Sensor.</i>	Digi Media	Content from Website	•	•
	Int Cam	Internal built in Camera	•	X
	Ext Video 1	External Video Source 1	•	X
	Ext Video 2	External Video Source 2	•	X
	DVI, Int Card	Internal Card Reader Video	X	X
Run Switcher <i>Activates the Switcher Video Settings.</i>	On	Activates the Switcher Settings	•	X
	Off	Deactivates the Switcher Settings	•	X
Switcher Dwell <i>Length of time the Switcher Video Settings will display on screen.</i>	5-59	Choose in seconds, the length of time that the Switcher Video Settings will display on screen before switching to the Main Video Settings.	•	X
Main Video Dwell <i>Length of time the Main Video Settings will display on screen.</i>	5-59	Choose in seconds, the length of time that the Main Video Settings will display on screen before switching to the Switcher Video Settings.	•	X

Note: Video Source and PIP Video Source cannot be set to the same input source.

Note: Run Switcher must be set to On to activate the settings in this menu.

Note: Once the Run Switcher is set to ON the Main Dwell can be set.

5.8 Using the Advanced Setup Menu

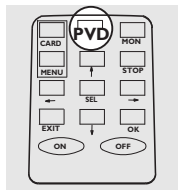

Access the menu by pressing the **PVD** button.
 Press the **↓** to choose **Advanced Setup**.
 Press **SEL**.

Use this menu to:

Reset the all menu settings to original Factory Defaults.

Rotate or mirror the on screen image.

Set the type of video to play through the Internal Card reader.

Choose the source of the audio input.

ADVANCED SETUP
FACTORY DEFAULT
FLIP/MIRROR
INT CARD SETUP
AUDIO SOURCE

Advanced Setup - Menu Options

• - Option Included X - Option Not Included

Feature	Option	Description	PVD Type	
			On Board Camera	No Camera
Factory Defaults <i>Reset all settings to the original Factory Defaults.</i>	On	Reset to Factory Defaults.	•	X
	Off	Set to On, the PVD will reset all settings and options and return to the OFF position allowing new changes.	•	X
Flip/Mirror <i>Rotates and/or mirrors the video on screen.</i>	Normal	Right Side up / Not Mirrored	•	•
	Mirror	Right Side Up / Mirrored Image	•	•
	Up Side Down	Rotates Image 180°	•	•
	Up Mir	Mirrors Image and Rotates 180°	•	•
Int Card Setup <i>Selects type of images from the Internal Card Reader.</i>	None	No Video or Slide show will play	•	X
	Slide Show	Still images will play from the internal card reader.	•	X
	w/Music	Motion Video will play from the internal card reader.	•	X
Audio Source <i>Selects Internal Audio or External Audio source.</i>	None	No Audio will play.	•	X
	Internal	Chooses Internal Audio Source	•	X
	External	Chooses External Audio Source	•	X

5.9 Using the MON Menu

Note: It is recommended that **NO** changes be made to the MON Set Up Menu as they may conflict with the NPVD's preconfigured circuit board programming.

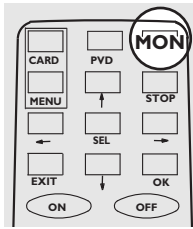

Access the menu by pressing the **MON** button.
 Press the ↓ to choose, press → choose option.
 Press **MON** to exit.

The MON Menu allows for minor adjustments to the picture quality of the monitor such as brightness, contrast, color, sharpness and tint.

MON MENU SELECTIONS

PICTURE
PIP/POP/PBP
SET UP

“MON” Menu Settings Overview

MON MENU	SUB MENU	2nd SUB MENU	CONTROL
Picture	Backlight		Factory Set 75% 0-100
	PMS (Pre-Set Monitor Settings by Type)		Factory Set Standard - Dynamic/Standard/Mild/Game User
		USER	
	CSM (Color Warmth settings for the Video on Screen)		Factory Set Normal
USER			Red/Green/Blue
PIP/POP/PBP	NOT AVAILABLE WITH THIS UNIT		No Settings will save.
SETUP	Language		English/Deutsch/François/Italiano/Espanol/Korean
	Transparency		0 (0~100)
	ISM Method		Factory Set Normal - DO NOT CHANGE
	Set ID on/Off		MUST BE SET TO (ON) - DO NOT CHANGE
	Set ID		MUST BE SET TO (I) - DO NOT CHANGE
	Flip		DO NOT CHANGE - USE PVD MENU FOR THIS OPTION
	Factory Reset		Defaults to Factory Settings
	Sound Source		N/A

MON Settings - Sub-Menu PICTURE

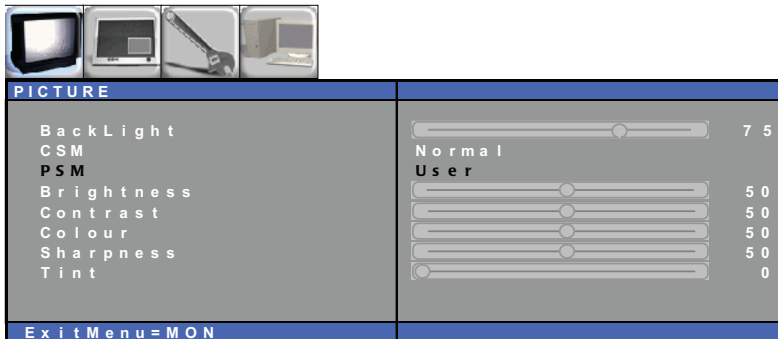
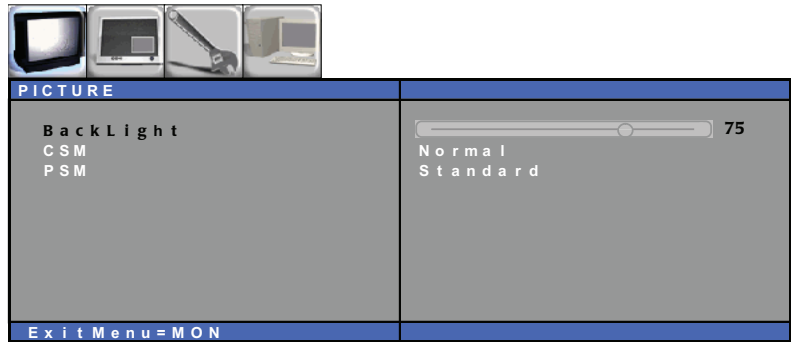

CSM - Color Warmth Settings : Factory Set to Normal
 Cool / Warm1 / Warm2

PSM - Pre-Set Monitor Settings By Type:
 Factory Set to : Standard
 Mild
 Game
 User: Customized by End User has its own sub menu
 Dynamic

PSM - Pre-Set Monitor Settings By Type:
 User Menu Adjust: / Brightness / Contrast/
 Color / Sharpness / Tint

5.9.1 Monitor Control Buttons

Note: It is recommended that Monitor Settings should be adjusted by using the Remote Control On Screen Display Menus, see **5.9 Using the MON Menu, not by using the Monitor Control Buttons.**

Adjustments to the Monitor Settings may be made by navigating through the menus and sub-menus with the buttons. See section **5.9 Using the MON Menu** for menu details.

Use the On/Off button to Reset the unit.

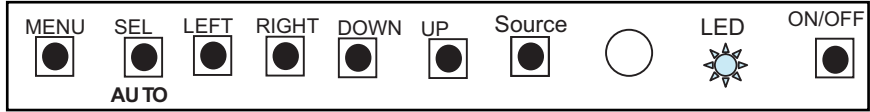

Button	Function	Status	HOTKey
LED	Indicates operation status	Green/ Off/ Amber	
Power	Power on/off	On/Off	
Menu	Activate menu		
Select	Menu Select		No OSD, Auto Adjust
LEFT	Cursor control Left	First Activate Menu Key	Volume Down
RIGHT	Cursor control Right	First Activate Menu Key	Volume Up
DOWN	Cursor control Down	First Activate Menu Key	
UP	Cursor control Up	First Activate Menu Key	
Source	Source change		

Figure 5: Internal Monitor Control Buttons

Power On and Off Button. Use this button to power on the unit for use.

Menu: Use this button to call up the On Screen Display (OSD) menus on the monitor and to exit the (OSD).

Select item from menu and to save changes after making adjustments.

Scroll **Down** the menu

Scroll **Up** the menu

Scroll **Left** on the menu

Scroll **Right** on the menu

Power LED Display Light:

Green Light indicates Video On

Amber Light indicates Video Loss

6. MOTION DETECTION

6.1 Adjust the Motion Sensor Orientation

1. To make any needed adjustments to the Motion Sensor (PIR) access the back panel of the NPVD by unscrewing the two thumb screws.
2. The motion sensor is located to the far left side of the panel as you are facing the back of the NPVD. See **Figure 6**.

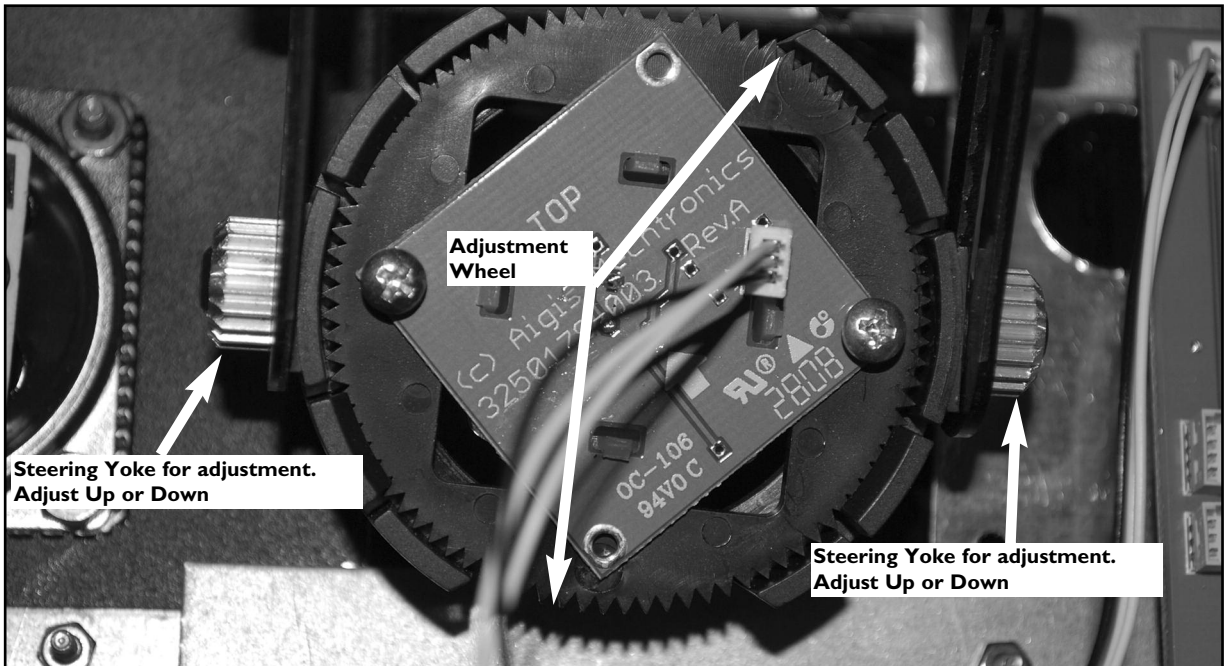
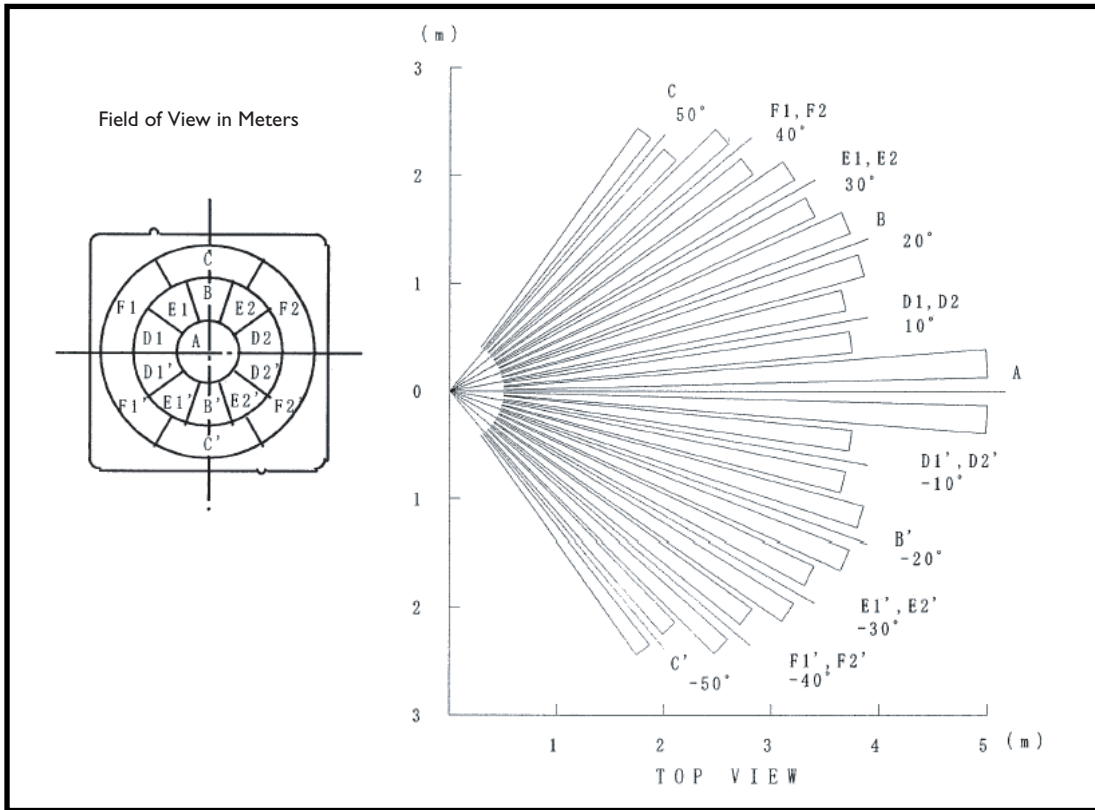

Figure 6: Motion Sensor

3. Adjustments can be made to the Sensor by rotating the adjustment wheel in either direction by moving it clockwise or counter clockwise. The sensor can also be moved in an up and down orientation by unscrewing slightly the steering yoke and sliding the sensor up or down then retightening.
4. The standard PIR detects motion by sensing left to right or right to left in a horizontal fashion. To change the orientation of the sensor simply begin adjustments as explained in step 3 until the sensor begins to detect in the field of view desirable.
5. The following chart may be helpful when determining the pattern of movement most desirable for the area the NPVD is installed in.

6.1.1 Motion Sensor Field of View in Meters

Top View



Side View

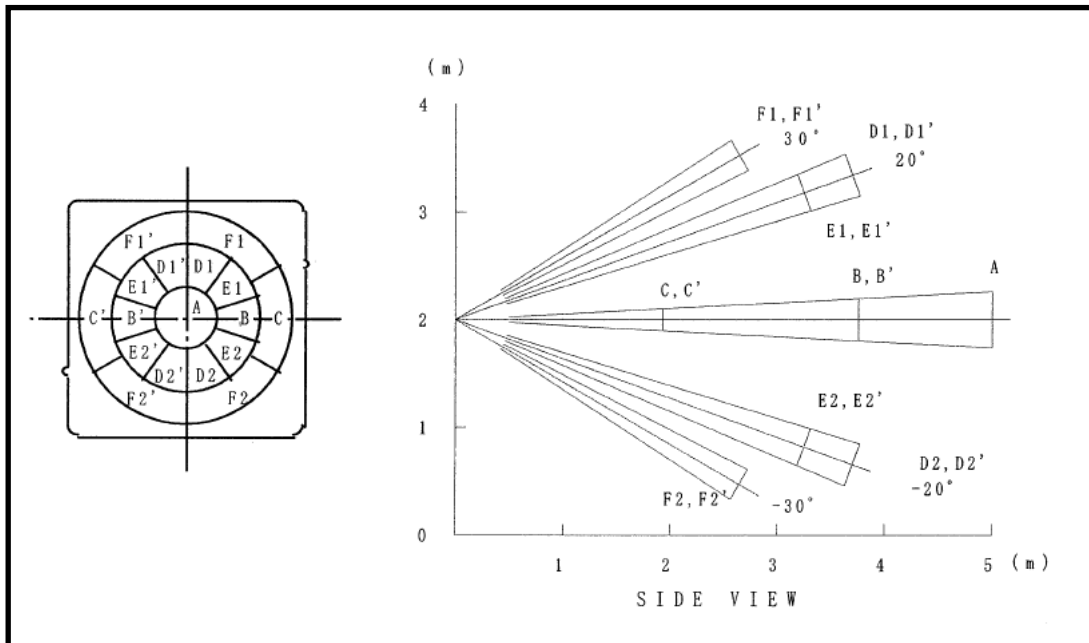

7. INTERNAL CONTROL BOARD

7.1 Control Board Configurations and Option Switches

The Control Board is a microprocessor-based circuit that controls the on-board sensors and the video switcher. The main purpose of this switcher is to select the Main Video settings to be displayed on screen and then switch the video to either Light Sensor, Motion Sensor or Switcher Video settings. It may also be directed to ignore the sensors and select one or both of the Main Video or Switcher Video settings at settable dwell rates.

Verify the operations of the Control Board

1. Located on the control board are the Control Board LED's. See **Figure 7**.
2. Verify that the "Power LED" is Green signifying the NPVD is on.
3. The "System Pulse LED" will be dull red showing the control board is running.
4. The "Camera On LED" is lit when the motion detection is selected and off when the auxiliary input is selected.

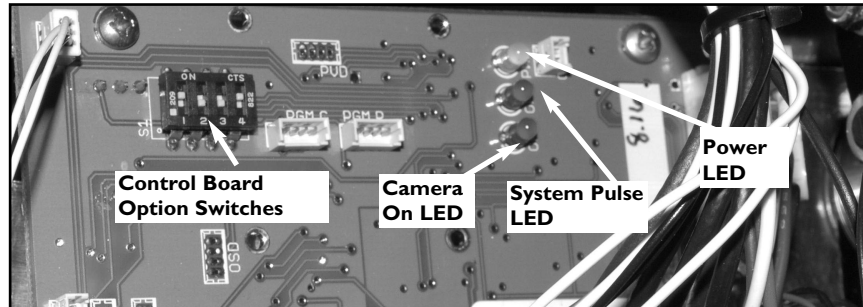

Figure 7: Control Board

7.2 Detail of Option Switches

Options may be controlled via the four "Option Switches," see **Figure 7**, see **Detail A** for their respective functions. It is advised to verify operation first by using the On Screen PVD Menu to control these options. After verification of settings via the PVD Menu the Control Board Option switches can be accessed.

Detail A

Note: is factory setup

1	Motion Switcher	ON	Enable Motion Switcher
		OFF	Disable Motion Switcher
2	Ambient Light Control	ON	Control of Aux Video Amp
		OFF	No Control of Aux Video Amp
3	Synchronization Mode	ON	Sync to Aux Video
		OFF	Sync to Line
4	Light Sensor	ON	Enable Light Sensor
		OFF	Disable Light Sensor

Figure 7 Detail A: Switches

Note: Option switches are only field - accessible in on-board camera models.

8 CAMERA ADJUSTMENTS

8.1 Color Camera Adjustments

Refer to the following sections to setup the camera for operation. The camera module position can be adjusted both vertically and horizontally and can also be rotated for proper tilt orientation.

See **Figure 7** for the correct camera series adjustment points.

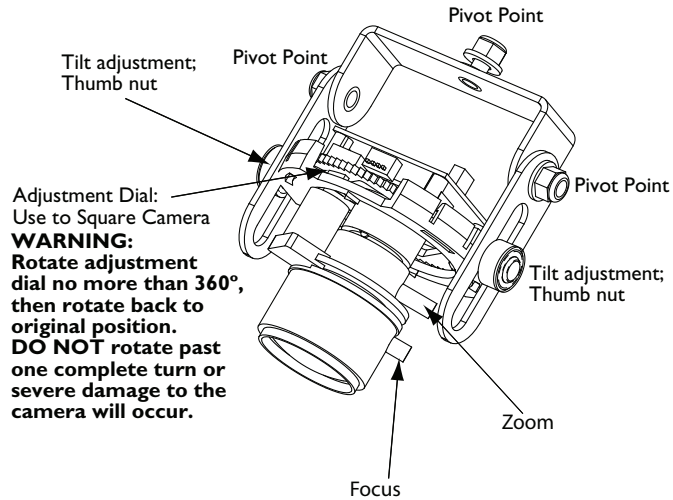

Figure 8: Camera Adjustment Points

8.2 Adjusting the Camera's Zoom and Focus Settings

Refer to **Figure 7** to locate the camera's zoom and focus knobs. Turn the knobs counter clockwise to loosen them. First adjust the zoom knob to the desired setting. Adjust the focus knob until the image is crisp and clear. Adjust the zoom knob for any fine tuning adjustments of the viewing angle, and then adjust the focus knob to clear up the image. Tighten the knobs to complete the installation.

DIMENSIONAL OUTLINES

NPVD 26"

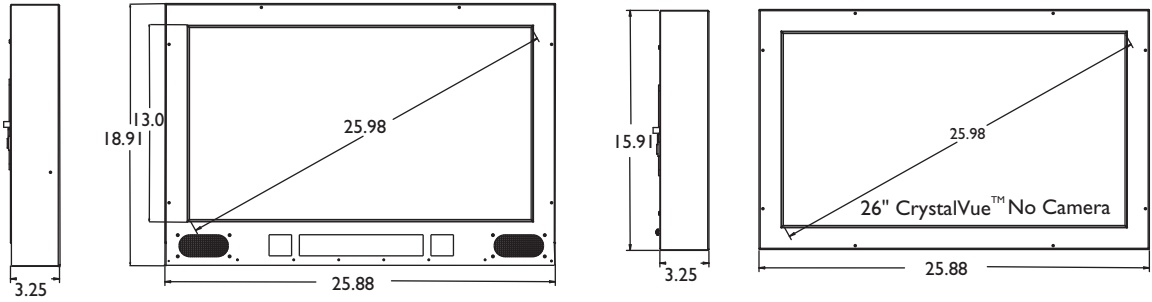

NPVD™ 32"

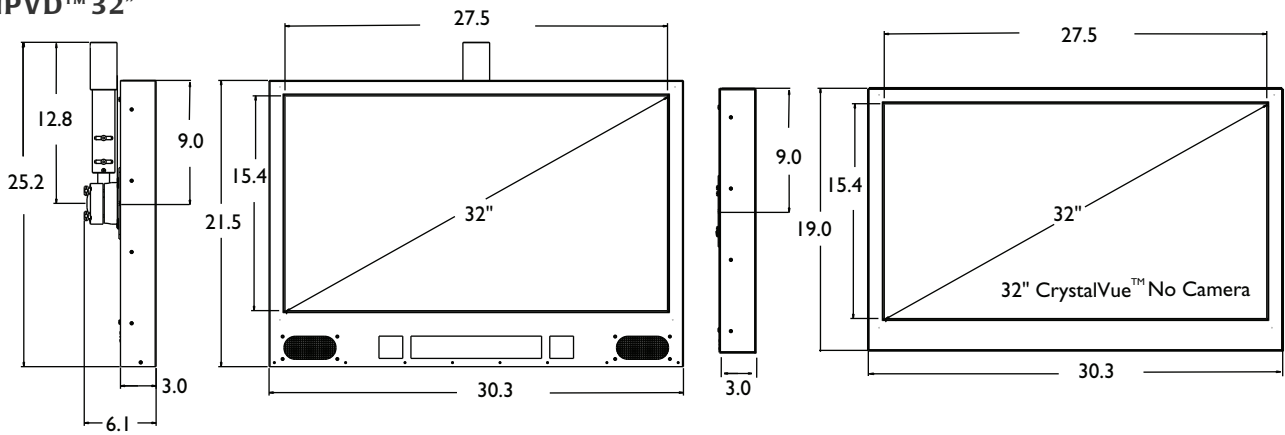



2010 Aigis Mechtronics
1124 Louise Road Winston-Salem, NC 27107-5450
Tel: 336.785.7740 Fax: 336.785.7744
Data subject to change without notice.

100 0250 001 AIG 01/10
Draft Printed in U.S.A.