

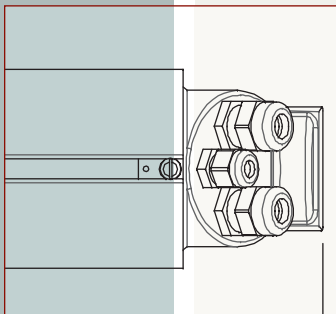

- For 1/3-inch or 1/2-inch Format CCD Cameras
- All Aluminum Construction
- Built-in Handle for Easy Installation
- Excellent Protection Against Dust & Water
- Optional Built-in Window Heater/Defogger
- Pressurization Model Option

Specialty Series Outdoor Housings

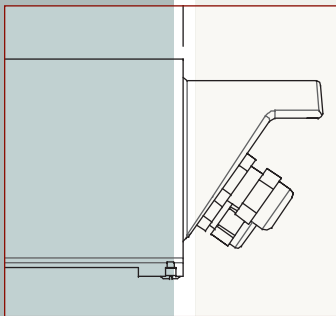
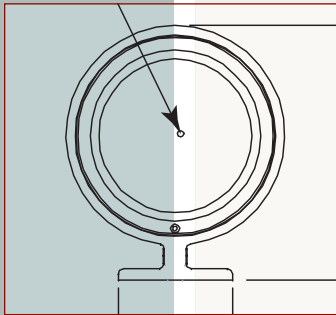

HS9384 Series

The HS9384 Specialty Series outdoor housings are designed to protect a camera and lens from harsh environments. These IP68/NEMA-6P rated housings are constructed of extruded aluminum and include a one-piece camera/lens mounting cradle with front and rear-end caps. The front-end cap contains the glass viewing window with an integral heater design that minimizes fogging of the window in high humidity areas or freezing under cold temperature conditions. The aluminum rear-end cap contains three liquid-tight fittings that permit pass-through of video coax, AC power, and lens control wiring. The pressurized version includes one I6-pin prewired connector.

The permanent base permits mounting to pan/tilts, adjustable heads, and various wall mounts, and the built-in handle on the back of the housing allows for quick installation and service.

ORDERING GUIDE

Order the housing that meets your needs. Start with the Model number, then specify your power requirements. Select from the options available to complete your custom housing. If you need further customization - call the factory with your exact specification requirements.

EXAMPLE: HS9384-6HP

model	power	heater	transformer	pressurization
HS9384	6	H	-	P
Specialty Outdoor Housing	2 - 24 VAC, 50/60 Hz 5 - 220 VAC, 50/60 Hz 6 - 115 VAC, 50/60 Hz	H - optional window Heater/Defogger	NT - optional Non-Transformer model	P - optional Pressurization model

OPTIONS		OPTION	
Nominal Power			30W (Heater requires 10 watts)
Rated Input (Voltage Range)		-2	24 VAC, 50/60 Hz (21.6 to 26.4)
		-5	220 VAC, 50/60 Hz (207 to 253)
		-6	115 VAC, 50/60 Hz (108 to 132)
Heater		-H	Includes thermostatically controlled window heater/defogger. (Heater requires 10 watts)
Power Transformer (Voltage Output)	Standard		The power transformers included with these housings are used to step voltage down to 24V and can be used to provide isolated camera power. (24 VAC, 50/60 Hz)
	Non-Transformer	-NT	Add -NT to order housing without transformer.
Cable Entry	Standard		Three liquid-tight fittings. Accepts the following cable diameters: one fitting 0.09 in to 0.25 in (2.3 mm to 6.4 mm), two fittings 0.15 in to 0.39 in (3.8 mm to 10 mm).
	Pressurization Models *	-P	One Corrosion-resistant 16-pin MIL-C-26482 connector with mating connector and crimp pins supplied. Connections for AC power, video, and lens control. Pressurization Model can be filled with Dry Nitrogen pressure upon request.

* Other connectors are available (eg. 11-pin). Call factory for specific requirements.

SPECIFICATIONS

Maximum Camera/Lens Size:

HS9384 Series: Accepts cameras up to 2.5 x 2.3 in (64 W x 58 H mm), lenses up to 2.6 x 2.9 in (67 W x 75 H mm), and camera/lens combinations up to 11.5 in (292 mm).

HS9384-NT (Non Transformer) Models:

Accepts cameras up to 2.5 x 2.3 in (64 W x 58 H mm), lenses up to 2.6 x 2.9 in (67 W x 75 H mm), and camera/lens combinations up to 14.0 in (355 mm).

Window:

0.118 in (3 mm) thick glass. Includes thermostatically-controlled window heater/defogger.

Housing Mounting:

Three (3) 1/4-20 tapped holes.

Camera Mounting:

Removable cradle assembly with hole pattern for mounting camera/lens assembly. Cradle may be rotated through 360°.

Construction:

Extruded aluminum housing, aluminum rear-end cap, aluminum front cap with glass faceplate, and aluminum cradle.

Finish: Light gray.

Dimensions: See drawings.

Weights:

HS9384 Series: 5.6 lb (2.5 kg).

Non-Transformer Models (NT): 4.4 lb (2.0 kg).

Pressurization Models (P): 5.7 lb (2.6 kg).

ENVIRONMENTAL

Temperature:

At external ambient temperatures of -40°F to 122°F (40°C to 50°C), maintains internal temperatures between -4°F to 131°F (-20°C to 55°C).

Salt Atmosphere: MIL-STD-810E, Method 509, Procedure I.

Enclosure Protection: IP68, Designed to meet NEMA-6P.

ELECTROMAGNETIC COMPATIBILITY

EMC Requirements:

Immunity: 89/336/EEC, EN50082-1.

Emission: 89/336/EEC, EN50081-1 Class B.

Safety:

CE: LVD Requirements: 73/23/EEC; EN60065.

UL: UL2044.

cUL: CSA 22.2, No.1.

ACCESSORIES

HS9384SS Sunshield: Provides protection from the direct rays of the sun and promotes cooling to reduce internal housing temperatures.

HS9384TK Tamper Resistant Kit: Includes screws and insertion tool to permit tamper-resistance for one housing.

HS9384NPT to PG11 Conversion Kit: Converts NPT cable entry holes to two PG11; includes 3/8-inch NPT plug.

MT9212: Wall mount, 20lb max load. (See Aigis Housing Mounts for additional mounting options.)

HS9384 SERIES DIMENSIONAL OUTLINE

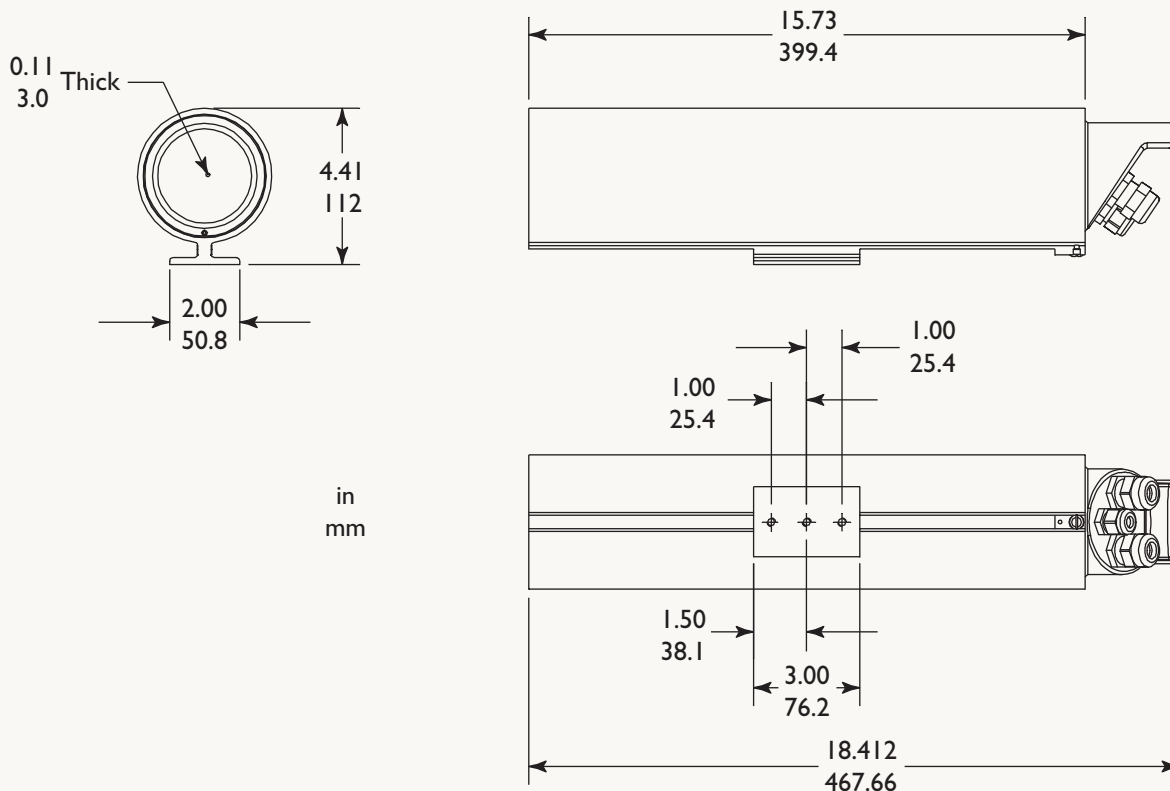

HS9384 PRESSURIZATION MODELS - DIMENSIONAL OUTLINE

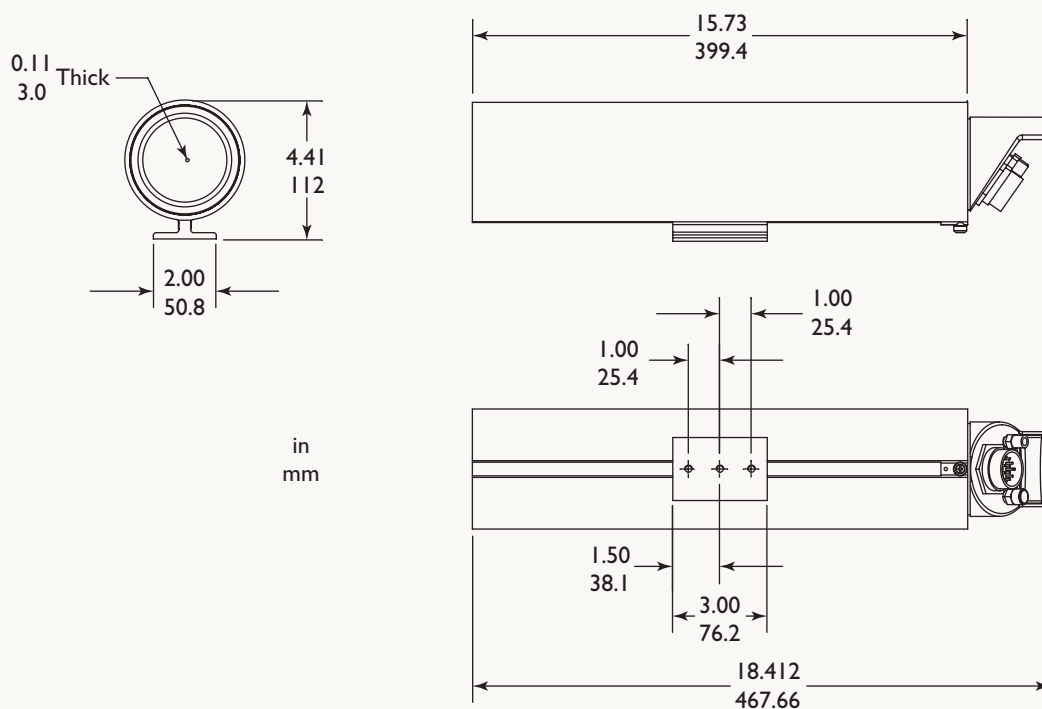

SUNSHIELD ACCESSORY - HS9384SS

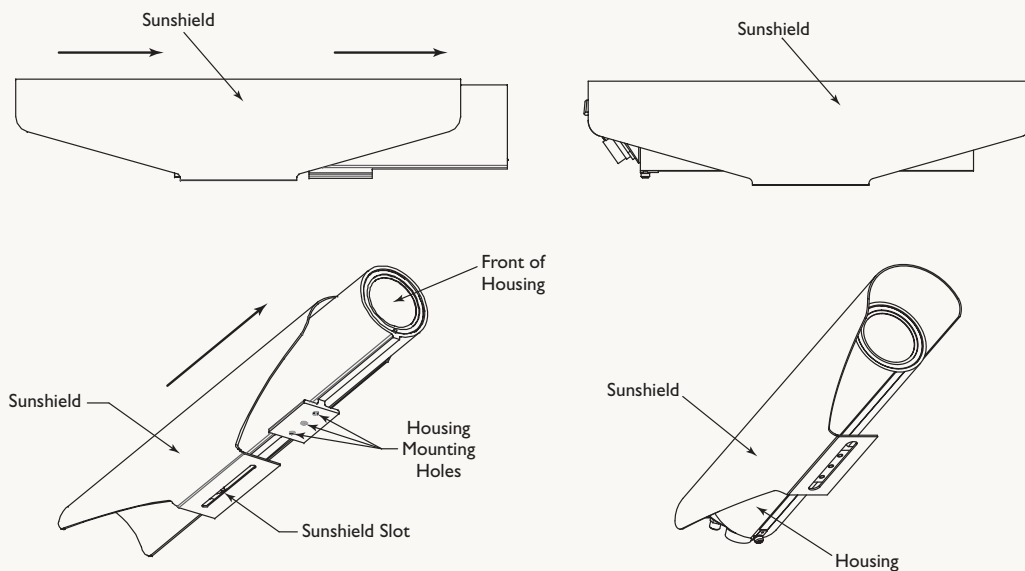

mechtronics

©2003 Aigis Mechtronics

1124 Louise Road, Winston-Salem, NC 27107-5450

Tel: 336.785.7740 Fax: 336.785.7744

www.aigismech.com

Data subject to change without notice

04/04 rev_01
Printed in U.S.A.